

18,034



March 1, 2023  
Office of County Commissioners  
PO Box 1097  
Greenville, TX 75403

FILED FOR RECORD  
at 1:00 o'clock P M

MAR 14 2023

**Overhead to Underground Facility Installation/Relocation  
Project Number: 20533051**

BECKY LANDRUM  
County Clerk, Hunt County, Tex.  
By

Greetings,

Oncor Electric Delivery LLC., is requesting permission to do work within the county right of way along County Road 1001. We are looking to install two new 45' class 5 wood poles, remove 3 existing wood poles. We will go underground in between these two new poles with 600' of 1/0 aluminum primary in 2" conduit. We will remove the two overhead spans of existing conductor.

Site location map and permit exhibit are enclosed. The permit exhibit details the proposed work. All underground conduits will have a minimum depth of 3'.

If you have any questions, please contact at any time.

Sincerely,

*Amanda Longorio*  
Engineer  
[Amanda.Longorio@oncor.com](mailto:Amanda.Longorio@oncor.com)  
Phone: 432-213-4450

*County Approval Section:*

Approved: \_\_\_\_\_ Denied: \_\_\_\_\_

Authorized Signature: \_\_\_\_\_ Date: \_\_\_\_\_

**LEGEND**

- PROPOSED POLE
- EXISTING POLE
- REMOVE POLE
- PROPOSED OVERHEAD CONDUCTOR
- EXISTING OVERHEAD CONDUCTOR
- PROPOSED UNDERGROUND CONDUCTOR
- EXISTING UNDERGROUND CONDUCTOR
- REMOVE CONDUCTOR
- PROPOSED DOWN GUY
- EXISTING DOWN GUY

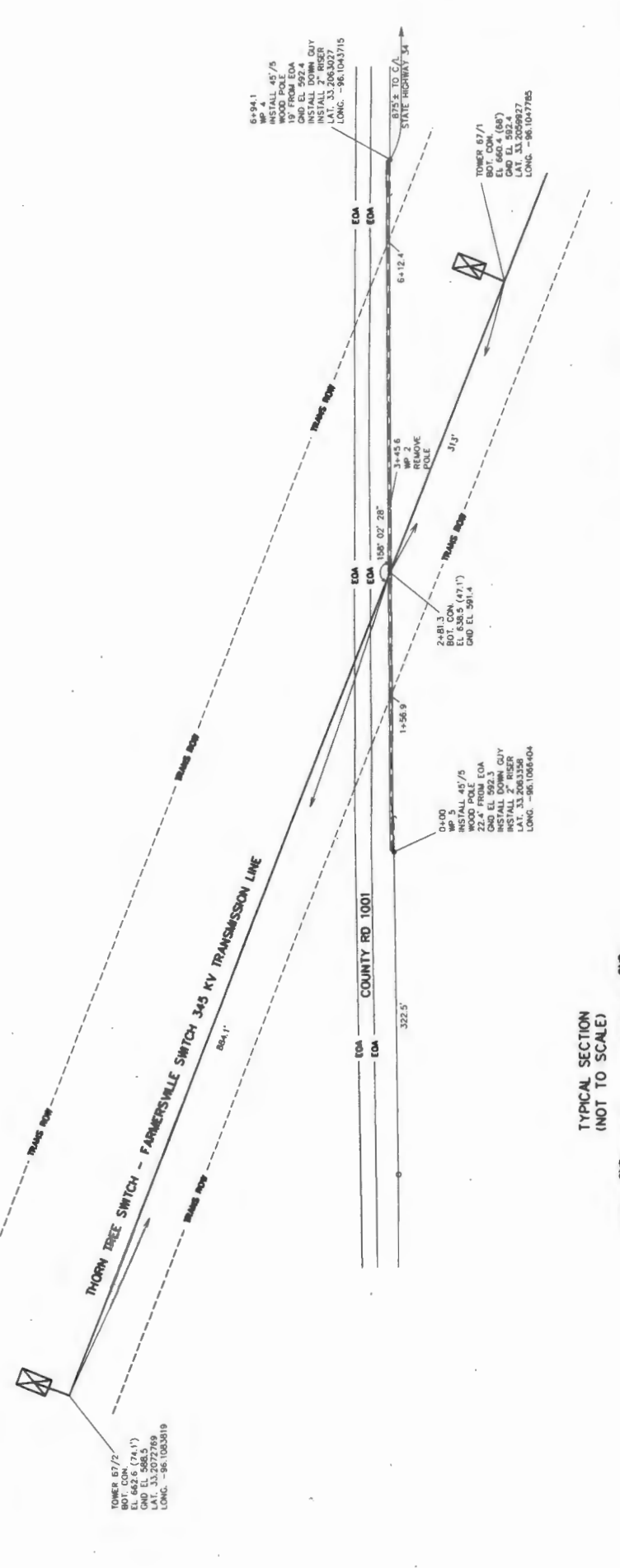

**MCKINNEY DISTRICT**

INSTALL 2-2" PVC CONDUIT IN EXISTING DISTRIBUTION LINE  
 CROSSING THORN TREE - FARMETSVILLE 345 KV LINE  
 ALONG COUNTY ROAD 1001 NEAR STATE HIGHWAY 34  
 IN THE CITY OF GREENVILLE, HART COUNTY



COMPANY	ONCOR
PROJECT NO.	10011346
DATE DRAWN	02-24-2023
DATE SURVEYED	02-20-2023
DRAWN BY	CORNELIUS SURVEYING INC.
DATE	02-24-2023
PROJECT NO.	10011346
PROJECT NAME	INSTALL 2-2" PVC CONDUIT IN EXISTING DISTRIBUTION LINE
PROJECT LOCATION	CROSSING THORN TREE - FARMETSVILLE 345 KV LINE ALONG COUNTY ROAD 1001 NEAR STATE HIGHWAY 34 IN THE CITY OF GREENVILLE, HART COUNTY
PROJECT ID	WORK20533051
SHEET NO.	1 OF 1

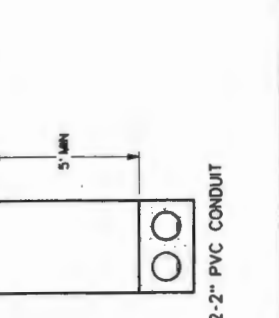

TIME OF SURVEY: 12:00 PM  
 TEMP. OF SURVEY: 65° F

ALL EXISTING UNDERGROUND UTILITIES MUST BE VERIFIED IN FIELD BY CONTRACTOR.